

XUPK1PANJ45

Photoelectric sensors XU, Picking Sensor
green/red PNP NO connector RJ45



Main

Range of product	Telemecanique Photoelectric sensors XU
Series name	Application
Electronic sensor type	Photo-electric sensor
Sensor name	XUPK
Detection system	Reflex Diffuse
Emission	Infrared
[Sn] nominal sensing distance	0.1 M 0.6 m
Discrete output function	1 NO
Discrete output type	PNP
Electrical connection	2 female connector: RJ45
Material	PC (polycarbonate)

Complementary

Operating mode	Point-to-point
Product destination	PLC
Topology	PLC program point-to-point
Device application	Picking system
Maximum sensing distance	0.15 M diffuse with dynamic threshold 0.6 m reflex with reflector
Maximum hysteresis	15 %
Output type	Solid state PNP (NO)
[Us] rated supply voltage	12...24 V
Discrete input voltage	12...24 V
Maximum output current	100 mA
Maximum voltage drop	<2 V output
Current consumption	<= 50 mA no-load
Maximum delay response	200 ms
Maximum delay recovery	200 ms
Status LED	2 LED color: green for parts to be taken 1 LED color: red for wrong taken
Switching capacity in mA	100 mA
Setting-up	Without sensitivity adjustment
Overvoltage category	II
Fixing mode	By clamp By screws
Depth	33 mm
Height	40 mm
Length	92 mm
Net weight	0.035 kg

Environment

Product certifications	CE
Ambient air temperature for operation	-10...60 °C
Environmental characteristic	EMC conforming to EN 60947-5-2

Packing Units

Unit Type of Package 1	PCE
Number of Units in Package 1	1
Package 1 Height	4.2 cm
Package 1 Width	6.5 cm
Package 1 Length	9.5 cm
Package 1 Weight	63 g
Unit Type of Package 2	S01
Number of Units in Package 2	24
Package 2 Height	15 cm
Package 2 Width	15 cm
Package 2 Length	40 cm
Package 2 Weight	1.702 kg

Offer Sustainability

California proposition 65	WARNING: This product can expose you to chemicals including: Diisononyl phthalate (DINP), which is known to the State of California to cause cancer, and Di-isodecyl phthalate (DIDP), which is known to the State of California to cause birth defects or other reproductive harm. For more information go to www.P65Warnings.ca.gov
For all Reach Rohs enquiries contact us at	sustainability@tesensors.com

Dimensions

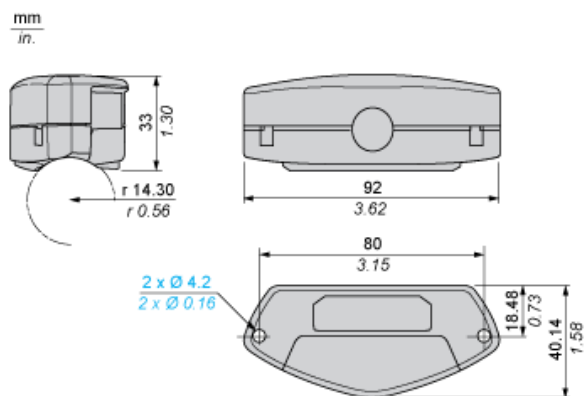
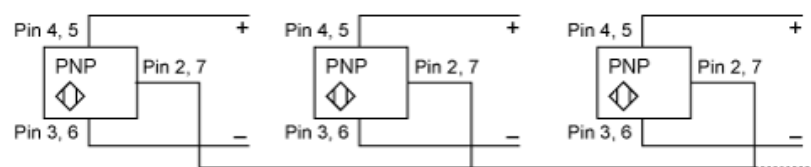

Diagram (1) illustrates the connection of a 4-core cable to a 4-core cable with a 12VDC power source. The diagram shows a 4-core cable (labeled 1) connected to a 4-core cable (labeled 2) which is connected to a 12VDC power source. The connections are as follows:

- Core 1 (Red) is connected to the positive terminal of the 12VDC power source.
- Core 2 (Blue) is connected to the negative terminal of the 12VDC power source.
- Core 3 (Green) is connected to the positive terminal of the 12VDC power source.
- Core 4 (Yellow) is connected to the negative terminal of the 12VDC power source.

[illegible]

Connection for Operating Mode



Detection Curves

Detection in a 10 mm/0.39 in. Tubular Beam

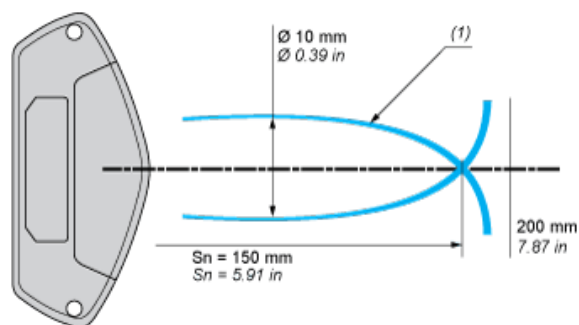

(1) Detection zone
 S_n : Sensing distance

Mounting

Mounting on a Flat Pannel (Fixation Holes M4)

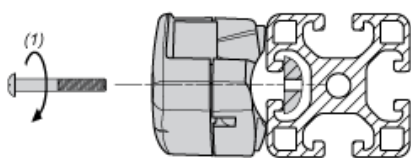
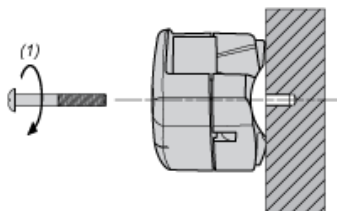

(1) Maximum tightening torque: 0,8 Nm / 7.08 lb-in.

Mounting on Tubes (with Plastic Clamps)

