

# XS7D1A1DAL2

Inductive proximity sensors XS, inductive sensor XS7 80x80x26, PBT, Sn40mm, 12...24 VDC, cable 2 m



## Main

|                                    |  |
|------------------------------------|--|
| Range of product                   | Telemecanique Inductive proximity sensors XS               |
| Series name                        | General purpose  |
| Sensor type                        | Inductive proximity sensor                                 |
| Device application                 | -  |
| Sensor name                        | XS7  |
| Sensor design                      | Flat form 80 x 80 x 26                                     |
| Size                               | 26 mm  |
| Body type                          | Fixed  |
| Detector flush mounting acceptance | Flush mountable  |
| Material                           | Plastic  |
| Enclosure material                 | PBT  |
| Type of output signal              | Discrete   |
| Wiring technique                   | 2-wire   |
| Discrete output function           | 1 NO   |
| Output circuit type                | DC   |
| Electrical connection              | Cable  |
| Cable length                       | 2 m  |
| [Us] rated supply voltage          | 12...24 V DC with reverse polarity protection              |
| Switching capacity in mA           | 1.5...100 mA DC with overload and short-circuit protection |
| IP degree of protection            | IP68 double insulation conforming to IEC 60529             |

## Complementary

|                          |                              |
|--------------------------|------------------------------|
| Detection face           | Frontal                      |
| Front material           | PBT                          |
| Operating zone           | 0...32 mm                    |
| Differential travel      | 1...15% of Sr                |
| Cable composition        | 2 x 0.34 mm <sup>2</sup>     |
| Wire insulation material | PVC                          |
| Status LED               | Output state: 1 LED (yellow) |
| Supply voltage limits    | 10...36 V DC                 |
| Maximum residual current | 0.5 mA open state            |
| Switching frequency      | <= 100 Hz                    |
| Maximum voltage drop     | <4 V (closed)                |
| Maximum delay first up   | 10 ms                        |
| Maximum delay response   | 10 ms                        |
| Maximum delay recovery   | 10 ms                        |
| Marking                  | CE                           |
| Depth                    | 26 mm                        |
| Height                   | 80 mm                        |
| Width                    | 80 mm                        |
| Net weight               | 0.34 kg                      |

## Environment

|                                       |   |
|---------------------------------------|---|
| Product certifications                | UL[RETURN]C-Tick[RETURN]CSA[RETURN]Ecolab                               |
| Ambient air temperature for operation | -25...70 °C   |
| Ambient air temperature for storage   | -40...85 °C   |
| Vibration resistance                  | 25 gn amplitude = +/- 2 mm (f = 10...55 Hz) conforming to IEC 60068-2-6 |
| Shock resistance                      | 50 gn for 11 ms conforming to IEC 60068-2-27                            |

## Packing Units

|                              |          |
|------------------------------|----------|
| Unit Type of Package 1       | PCE      |
| Number of Units in Package 1 | 1        |
| Package 1 Height             | 6.8 cm   |
| Package 1 Width              | 9.8 cm   |
| Package 1 Length             | 13.3 cm  |
| Package 1 Weight             | 364.0 g  |
| Unit Type of Package 2       | S02      |
| Number of Units in Package 2 | 10       |
| Package 2 Height             | 15 cm    |
| Package 2 Width              | 30 cm    |
| Package 2 Length             | 40 cm    |
| Package 2 Weight             | 4.062 kg |
| Unit Type of Package 3       | P06      |
| Number of Units in Package 3 | 160      |
| Package 3 Height             | 75 cm    |
| Package 3 Width              | 40 cm    |
| Package 3 Length             | 80 cm    |
| Package 3 Weight             | 83.24 kg |

## Offer Sustainability

|  |   |
|--|---|
| Sustainable offer status                   | Green Premium product   |
| Circularity Profile                        | No need of specific recycling operations  |
| California proposition 65                  | WARNING: This product can expose you to chemicals including: Diisononyl phthalate (DINP), which is known to the State of California to cause cancer, and Di-isodecyl phthalate (DIDP), which is known to the State of California to cause birth defects or other reproductive harm. For more information go to <a href="http://www.P65Warnings.ca.gov">www.P65Warnings.ca.gov</a> |
| For all Reach Rohs enquiries contact us at | <a href="mailto:sustainability@tesensors.com">sustainability@tesensors.com</a>  |

## Contractual warranty

|          |           |
|----------|-----------|
| Warranty | 18 months |
|----------|-----------|

## Dimensions

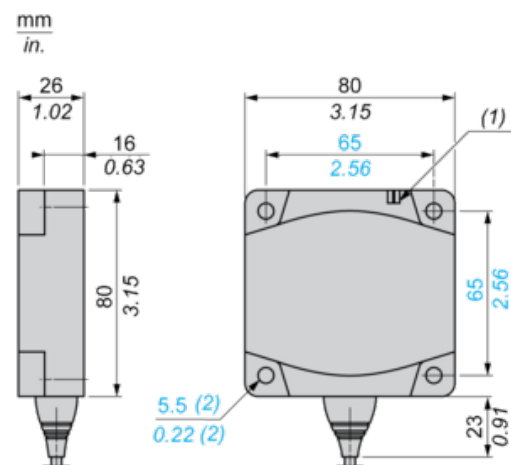

(1) LED

(2) For CHC type screws

---

## Setting-up

---

### Minimum Mounting Distances (mm)

Side by Side

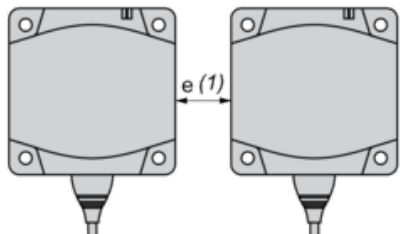

$$e (1) \geq 120$$

Face to Face

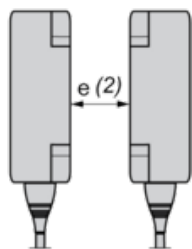

$$e (2) \geq 300$$

Facing a Metal Object

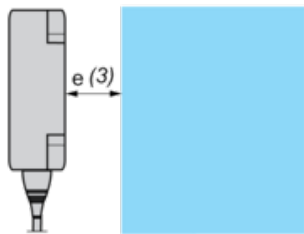

$$e (3) \geq 120$$

---

## Wiring Schemes

---

### 2-Wire NO

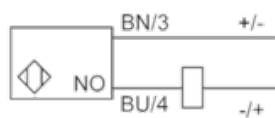

BU : Blue

BN : Brown