

XCJ121C

Short flat lever, roller end plunger, one side actuation



Main

| | |
|------------------------------|--------------------------------------------------------------------|
| Range of product | OsiSense XC |
| Series name | Basic |
| Product or component type | Limit switch |
| Product specific application | Light to medium duty |
| Device short name | XCJ |
| Body type | Fixed |
| Head type | Plunger head |
| Material | Plastic |
| Fixing mode | By the body |
| Movement of operating head | Linear |
| Type of operator | Roller lever plunger thermoplastic short and flat, retractable |
| Switch actuation | By 30° cam |
| Type of approach | Lateral approach, 2 directions |
| Electrical connection | Screw-clamp terminals |
| Cable entry | 1 flexible rubber cable gland, cable outer diameter: 8.5...10.5 mm |
| Number of poles | 1 |
| Contact operation | Snap action |
| Positive opening | Without |
| Maximum force for tripping | 2.4 N |

Complementary

| | |
|----------------------------------------|--------------------------------------------------------------------------------------------------------------------------------------------|
| Contacts insulation form | C |
| Minimum release force | 0.98 N |
| Minimum actuation speed | 0.01 mm/s |
| Maximum actuation speed | 0.5 m/s |
| Maximum operating rate | 120 cyc/mn |
| Contact code designation | A300, AC (Ue = 240 V), Ie = 10 A, lthe = 10 A conforming to IEC 60947-5-1 R300, DC (Ue = 220 V), Ie = 0.3 A conforming to IEC 60947-5-1 |
| Maximum resistance across terminals | 25 MOhm |
| [Uimp] rated impulse withstand voltage | 4 kV conforming to IEC 60664 |
| Electrical durability | 800000 cycles, AC, 10 A, 220 V |
| Mechanical durability | 10000000 cycles |
| Width | 22 mm |
| Height | 72 mm |
| Depth | 71 mm |
| Net weight | 0.085 kg |
| Terminals description ISO n°1 | (NO-NC-C)OF |

Environment

| | |
|---------------------------------------|--------------------------------------------------------|
| Shock resistance | 10 gn for 11 ms conforming to IEC 60068-2-27 |
| Vibration resistance | +/- 0.7 mm (f= 10...55 Hz) conforming to IEC 60068-2-6 |
| IP degree of protection | IP40 conforming to IEC 60529 |
| Electrical shock protection class | Class II conforming to IEC 60947-5-1 |
| Ambient air temperature for operation | -25...70 °C |
| Ambient air temperature for storage | -40...70 °C |
| Marking | CE CCC |
| Standards | IEC 60947-5-1 GB 14048.5 |

Packing Units

| | |
|------------------------------|-----------|
| Unit Type of Package 1 | PCE |
| Number of Units in Package 1 | 1 |
| Package 1 Height | 2.000 cm |
| Package 1 Width | 7.000 cm |
| Package 1 Length | 7.500 cm |
| Package 1 Weight | 66.000 g |
| Unit Type of Package 2 | BB1 |
| Number of Units in Package 2 | 10 |
| Package 2 Height | 8.000 cm |
| Package 2 Width | 8.500 cm |
| Package 2 Length | 22.000 cm |
| Package 2 Weight | 704.000 g |
| Unit Type of Package 3 | S03 |
| Number of Units in Package 3 | 150 |
| Package 3 Height | 30.000 cm |
| Package 3 Width | 30.000 cm |
| Package 3 Length | 40.000 cm |
| Package 3 Weight | 10.971 kg |

Offer Sustainability

| | |
|--------------------------------------------|----------------------------------------------------------------------------------------------------------------------------------------------------------------------------------------------------------------------------------------------------------------------------------------------------------------------------------------------------------------------------------|
| California proposition 65 | WARNING: This product can expose you to chemicals including: Diisononyl phthalate (DINP), which is known to the State of California to cause cancer, and Diisodecyl phthalate (DIDP), which is known to the State of California to cause birth defects or other reproductive harm. For more information go to www.P65Warnings.ca.gov |
| For all Reach Rohs enquiries contact us at | sustainability@tesensors.com |

Contractual warranty

| | |
|----------|-----------|
| Warranty | 18 months |
|----------|-----------|

Dimensions

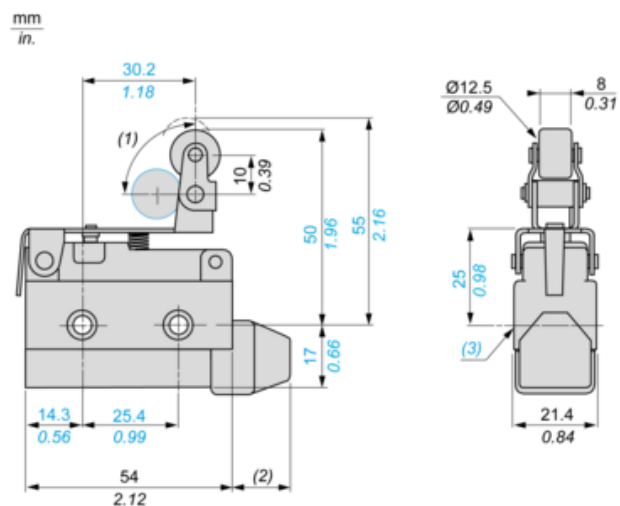

(1) : 90° max

(2) : 16.5 mm max / 0.64 in. max

(3) : 2 x Ø4.2 mm / 2 x Ø0.16 mm

Connection and Schema

Wiring Diagram

Single pole 1C/O



Technical Description

Type of Operator and Functional Diagram, Travel Distance

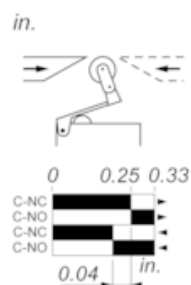
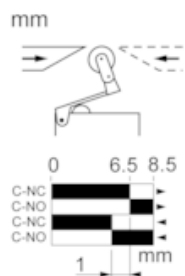

- (1)
- (2)
- ▶ (3)
- ◀ (4)

- (1) : Contact closed
- (2) : Contact open
- (3) : Tripping
- (4) : Resetting