

Product datasheet

Specifications



circuit breaker EasyPact EZC630H - TMD - 500 A - 4 poles 3d

EZC630H4500N

Main

Range of product	EasyPact
Product or component type	Circuit breaker
Device short name	EasyPact EZC630H
Circuit breaker name	EasyPact EZC630H
Device application	Distribution
Poles description	4P
Protected poles description	3t
Network type	DC AC
Network frequency	50/60 Hz
[In] rated current	630 A at 40 °C
[Ui] rated insulation voltage	690 V AC 50/60 Hz conforming to IEC 60947-2
[Uimp] rated impulse withstand voltage	6 kV conforming to IEC 60947-2
[Ue] rated operational voltage	250 V DC conforming to IEC 60947-2 440 V AC 50/60 Hz conforming to IEC 60947-2
Breaking capacity code	H
Breaking capacity	50 kA Icu at 380 V AC 50/60 Hz conforming to IEC 60947-2 50 kA Icu at 440 V AC 50/60 Hz conforming to IEC 60947-2 70 kA Icu at 220/230 V AC 50/60 Hz conforming to IEC 60947-2 50 kA Icu at 400/415 V AC 50/60 Hz conforming to IEC 60947-2
[Ics] rated service breaking capacity	25 kA at 440 V AC 50/60 Hz conforming to IEC 60947-2 70 kA at 220/230 V AC 50/60 Hz conforming to IEC 60947-2 50 kA at 380 V AC 50/60 Hz conforming to IEC 60947-2 50 kA at 400/415 V AC 50/60 Hz conforming to IEC 60947-2
Suitability for isolation	Yes conforming to IEC 60947-2
Utilisation category	Category A
Trip unit name	TM-D
Trip unit technology	Thermal-magnetic
Trip unit rating	500 A at 50 °C
Protection type	Short-circuit protection Overload protection
Pollution degree	3 conforming to IEC 60947

Complementary

Control type	Toggle
Mounting mode	Fixed
Mounting support	Backplate
Upside connection	Front
Downside connection	Front
Mechanical durability	10000 cycles
Electrical durability	Category A: 1000 cycles 415 V AC 50/60 Hz conforming to IEC 60947-2
Connection pitch	44 mm
Local signalling	Positive contact indication
Contact position indicator	Yes
Magnetic tripping current	5000 A
Neutral protection setting	Without protection
Long time pick-up adjustment type Ir	Fixed
Long time delay adjustment type	Fixed
Earth-leakage protection	Without
Height	255 mm
Width	185 mm
Depth	140 mm
Net weight	4.8 kg
Quantity per set	1 piece
Colour	Black

Environment

Standards	JIS C8201-2-2 GB/T 14048.2 EN/IEC 60947-1 EN/IEC 60947-2
IP degree of protection	IP20 conforming to IEC 60529
IK degree of protection	IK07 conforming to EN 50102
Ambient air temperature for operation	-25...70 °C
Ambient air temperature for storage	-35...85 °C

Packing Units

Unit Type of Package 1	PCE
Number of Units in Package 1	1
Package 1 Height	15.5 cm
Package 1 Width	20.0 cm
Package 1 Length	30.0 cm
Package 1 Weight	8.0 kg
Unit Type of Package 2	S04
Number of Units in Package 2	3

Package 2 Height	30.0 cm
Package 2 Width	40.0 cm
Package 2 Length	60.0 cm
Package 2 Weight	24.6 kg
Unit Type of Package 3	PAL
Number of Units in Package 3	36
Package 3 Height	80.0 cm
Package 3 Width	120.0 cm
Package 3 Length	36.0 cm
Package 3 Weight	278.0 kg

Offer Sustainability

Sustainable offer status	Green Premium product
REACH Regulation	REACH Declaration
REACH free of SVHC	Yes
EU RoHS Directive	Compliant EU RoHS Declaration
Mercury free	Yes
China RoHS Regulation	China RoHS declaration
RoHS exemption information	Yes
Environmental Disclosure	Product Environmental Profile
Circularity Profile	End of Life Information
WEEE	The product must be disposed on European Union markets following specific waste collection and never end up in rubbish bins
PVC free	Yes

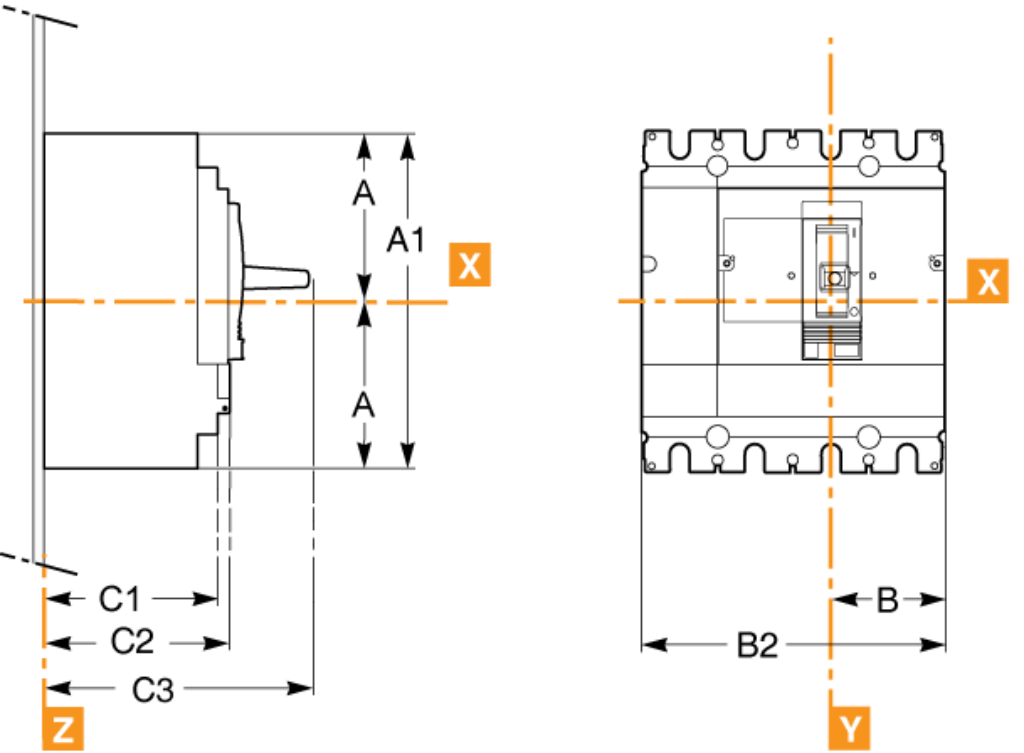

A	A1	B	B1	B2	F1	F2	F3
127.5	255	70	140	185	45	22.5	90

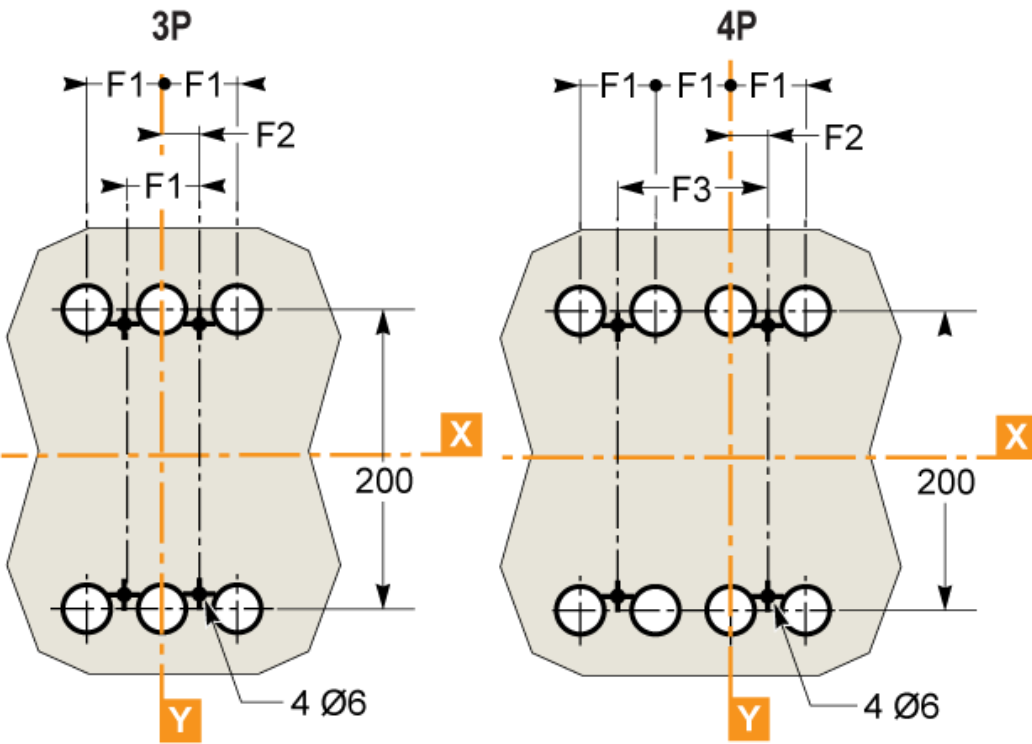

A	A1	B	B1	B2	F1	F2	F3
127.5	255	70	140	185	45	22.5	90

Performance Curves

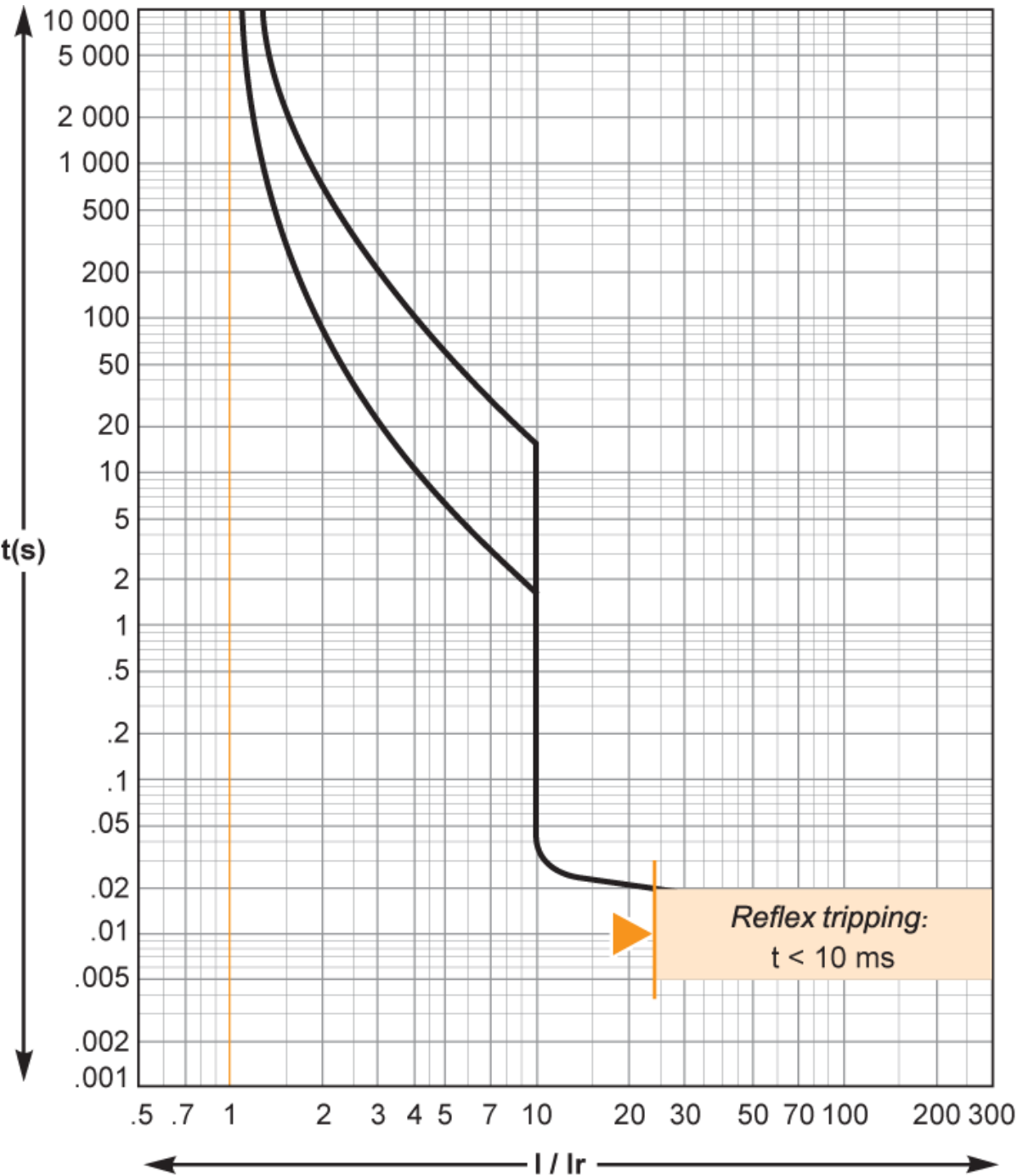

Dimensions



Recommended replacement(s)