



bus connectors broadened front mounted; 3 units extended pole-center distance for India

| Model | |
|---|--|
| product brand name | SETRON |
| product designation | accessories |
| design of the product | front bus connectors broadened 3 units |
| accessories | Bus connector offset |
| General technical data | |
| designation / of the terminal | screw-type termination |
| Connections according IEC | |
| connectable conductor cross-section | |
| • for copper cable / stranded / minimum | 120 mm² |
| • for copper cable / stranded / maximum | 370 mm² |
| type of connectable conductor cross-sections / of the laminated conductor rails | |
| • maximum | 1x60x12.5 |
| tightening torque / when using copper cables | |
| • stranded | 30 |
| thickness / of the busbar | |
| • minimum | 5 ... 12.5 |
| • maximum | |
| width / of the busbar / maximum | 60 mm |
| Certificates | |
| General Product Approval | |
| Marine / Shipping | |



[Confirmation](#)



[Miscellaneous](#)



| other | Environment |
|-------------------------------|---|
| Confirmation | Environmental Confirmations |
| Miscellaneous | |

| Further information |
|---|
| Information on the packaging https://support.industry.siemens.com/cs/ww/en/view/109813875 Information- and Downloadcenter (Catalogs, Brochures,...) http://www.siemens.com/lowvoltage/catalogs Industry Mall (Online ordering system) |

<https://mall.industry.siemens.com/mall/en/en/Catalog/product?mlfb=3VM9483-0QC50>

Service&Support (Manuals, Certificates, Characteristics, FAQs,...)

<https://support.industry.siemens.com/cs/ww/en/ps/3VM9483-0QC50>

Image database (product images, 2D dimension drawings, 3D models, device circuit diagrams, ...)

http://www.automation.siemens.com/bilddb/cax_en.aspx?mlfb=3VM9483-0QC50

CAX-Online-Generator

<http://www.siemens.com/cax>

Tender specifications

<http://www.siemens.com/specifications>

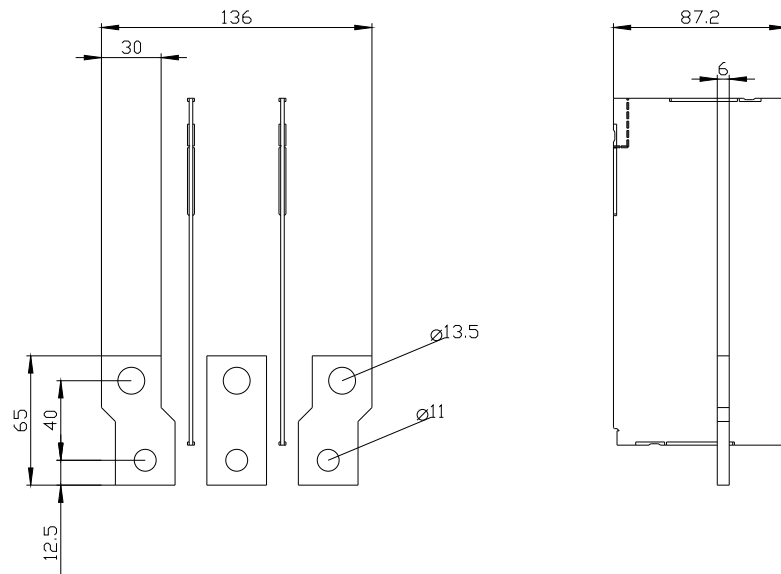

last modified:

8/19/2022 

