

bus connectors broadened front mounted; 3 units accessory for: 3VM10/11  
extended pole-center distance for India

Model	
product brand name	SETRON
product designation	accessories
design of the product	front bus connectors broadened 3 units
accessories	Bus connector offset
General technical data	
designation / of the terminal	screw-type termination
Connections according IEC	
connectable conductor cross-section	
• for copper cable / stranded / minimum	2.5 mm <sup>2</sup>
• for copper cable / stranded / maximum	70 mm <sup>2</sup>
type of connectable conductor cross-sections / of the laminated conductor rails	
• minimum	1 x 30mm x 2mm
• maximum	1x30x8
tightening torque / when using copper cables	
• stranded	12
thickness / of the busbar	
• minimum	2 ... 8
• maximum	
width / of the busbar / maximum	30 mm
Certificates	
General Product Approval	EMV

[Confirmation](#)



[Miscellaneous](#)



other	Environment
<a href="#">Confirmation</a>	<a href="#">Environmental Con- firmations</a>
	<a href="#">Environmental Con- firmations</a>

Further information
Information on the packaging <a href="https://support.industry.siemens.com/cs/ww/en/view/109813875">https://support.industry.siemens.com/cs/ww/en/view/109813875</a> Information- and Downloadcenter (Catalogs, Brochures,...) <a href="http://www.siemens.com/lowvoltage/catalogs">http://www.siemens.com/lowvoltage/catalogs</a>

Industry Mall (Online ordering system)

<https://mall.industry.siemens.com/mall/en/en/Catalog/product?mlfb=3VM9153-0QC50>

Service&Support (Manuals, Certificates, Characteristics, FAQs,...)

<https://support.industry.siemens.com/cs/ww/en/ps/3VM9153-0QC50>

Image database (product images, 2D dimension drawings, 3D models, device circuit diagrams, ...)

[http://www.automation.siemens.com/bilddb/cax\\_en.aspx?mlfb=3VM9153-0QC50](http://www.automation.siemens.com/bilddb/cax_en.aspx?mlfb=3VM9153-0QC50)

CAX-Online-Generator

<http://www.siemens.com/cax>

Tender specifications

<http://www.siemens.com/specifications>

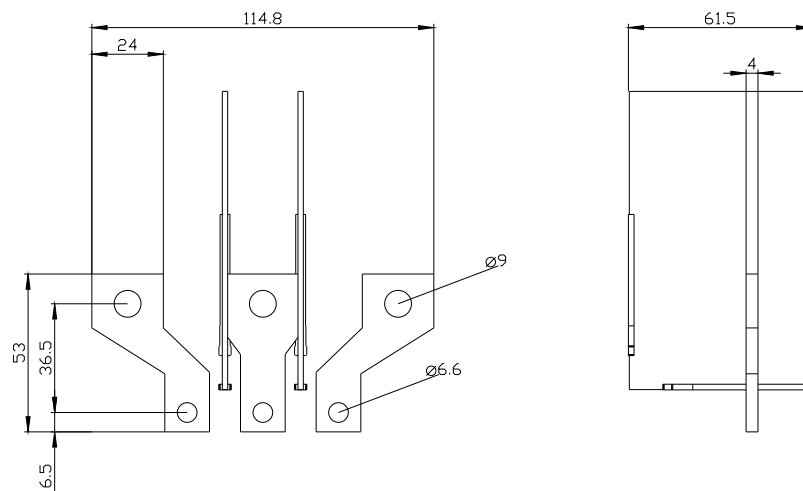

last modified:

7/5/2024 

