

PRODUCT-DETAILS

AUX T1...T6 3Q 1SY 24 Vdc

AUX T1...T6 3Q 1SY 24 Vdc

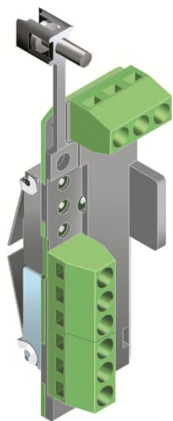

| General Information | |
|-----------------------|--|
| Extended Product Type | AUX T1...T6 3Q 1SY 24 Vdc |
| Product ID | 1SDA054914R1 |
| EAN | 8015644560430 |
| Catalog Description | AUX T1...T6 3Q 1SY 24 Vdc |
| Long Description | 3 CHANGEOVER CONTACTS OPEN-CLOSED + 1 CHANGEOVER FOR TRIPPED INDICATION V <(><<)> 24V DC T1-T2-T3-T4-T5-T6 |

| Circular Value | |
|---|-----------------|
| Conflict Minerals Reporting Template (CMRT) | 9AKK108467A5658 |
| Toxic Substances Control Act - TSCA | 9AKK108467A8326 |

| Environmental | |
|---------------------------|-----------------|
| Environmental Information | 9AKK108467A6707 |
| REACH Declaration | 9AKK108466A1425 |
| RoHS Information | 9AKK108466A1424 |

RoHS Status Following EU Directive 2011/65/EU and Amendment 2015/863 July 22, 2019

Ordering

| | |
|------------------------|---------------|
| EAN | 8015644560430 |
| Minimum Order Quantity | 1 piece |
| Customs Tariff Number | 85389099 |

Dimensions

| | |
|--------------------|---------|
| Product Net Weight | 0.04 kg |
|--------------------|---------|

Container Information

| | |
|--------------------------------|---------------|
| Package Level 1 Units | 1 piece |
| Package Level 1 Width | 110 mm |
| Package Level 1 Height | 60 mm |
| Package Level 1 Depth / Length | 140 mm |
| Package Level 1 Gross Weight | 0.077 kg |
| Package Level 1 EAN | 8015644560430 |

Additional Information

| | |
|--|------------------------|
| Configuration Type | Loose or configurable |
| Number of Auxiliary Contacts CO (SPDT) | 2 |
| Product Main Type | Accessories for Tmax T |
| Product Name | Accessory |
| Product Type | Accessory |
| Standards | IEC |
| Suitable For | T1, T2, T3, T4, T5, T6 |
| Suitable for Product Class | SACE Tmax T |

Certificates and Declarations

| | |
|-----------------------------------|---|
| Data Sheet, Technical Information | 1SDC210015D0208 1SDC210300D0201 |
| Declaration of Conformity - CE | Refer to the EU Declaration of the relative Circuit Breaker |
| Instructions and Manuals | 1SDH000436R0609 |

Classifications

| | |
|----------------------------|------------------------------------|
| ETIM 7 | EC000041 - Auxiliary contact block |
| ETIM 8 | EC000041 - Auxiliary contact block |
| ETIM 9 | EC000041 - Auxiliary contact block |
| Object Classification Code | Q |

| | |
|---------------|--|
| UNSPSC | 39120000 |
| WEEE Category | 5. Small Equipment (No External Dimension More Than 50 cm) |
| eClass | V11.1 : 27371302 |

Categories

Low Voltage Products and Systems → Circuit Breakers → Moulded Case Circuit Breakers → Accessories for Tmax T

